

# PCTEL® WiFi Low-Profile Antenna - BMLPV Series

BMLPV SERIES



## Low-Profile WiFi Antenna for 2.4 and 5 GHz applications

The BMLPVDB2458 antenna is a low-profile antenna from PCTEL® for WIFI applications. Its low height and the robust design provide even in demanding environments for safe operation. In Combination with the vandalism-proof mounting foot (MVPHP, see accessories) the antenna is also suitable for applications with occasional shocks in industrial environments environment. The antenna can be used both indoors and outdoor. Besides the mechanical characteristics, the BMLPVDB2458 also has excellent receiving characteristics in both WIFI bands and thus provides a secure connectivity of your WIFI applications.

- Low-profile design for extremely stable mechanical properties
- Excellent reception and efficiency characteristics for stable WIFI connectivity
- Numerous accessory options allow the installation in any situation

MODELLE	DESCRIPTION	ANTENNA CONNECTOR	ANTENNA CABLE
BMLPVDB2458	Low-profile WiFi antenna with universal plug for different mounting methods using the accessories listed	Universal Plug	See accessories table or cable configurator

# PCTEL® WiFi Low-Profile Antenna - BMLPV Series

## PRODUCT FEATURES



### WiFi support

Supports 2.4 GHz and 5 GHz WiFi.



### Omnidirectional antenna

Omnidirectional radiation characteristic ideal for most applications.



### Frequency range

This antenna offers 2.4-2.5 and 4.9-5.9 GHz frequency range.



### Antenna gain

3 / 4 dBi antenna gain.



### IP67 protection

Suitable for outdoor use with IP67 protection against water and dust.

# PCTEL® WiFi Low-Profile Antenna - BMLPV Series

## SPECIFICATIONS

BMLPVDB2458	
Antenna elements	1 x WiFi (2.4 and 5 GHz)
Frequency range	2.4 - 2.5 GHz, 4.9 - 5.9 GHz
Antenna gain	3/4 dBi
Antenna cable	Flexible, see table of accessories or cable configurator
Antenna connector	Universal Plug, can be combined with mounting accessories (see table of accessory components)
Compatible with	WiFi (2.4 and 5 GHz), Bluetooth

GENERAL INFORMATION	
Antenna type	WiFi-Antenna
Construction type	Low-Profile Antenna
Application area	Indoor/Outdoor
Radiation characteristic	Omnidirectional
Integrated Antenna elements	1 x WiFi (2.4 and 5 GHz)
Groundplane needed?	Yes
WiFi-frequencies	2.4 / 5 GHz
Gain (typical)	3/4 dBi
VSWR	<2.0:1

ELECTRICAL CHARACTERISTICS	
Transmission power (max)	100 W
Impedance	50 Ohm
Polarization	Vertikal

PHYSICAL CHARACTERISTICS	
Material	XENOY 5720U-7014, UV-Stable
Dimensions	36.53 x 45.34 mm (Diameter x height)
Protection class	IP67
Mounting options	Screw mounting, Wall mounting, Magnetic foot mounting, Pole mounting
Operating temperature range	-40 - +85°C

# PCTEL® WiFi Low-Profile Antenna - BMLPV Series

RADIATION PATTERN

2450MHz - AZ

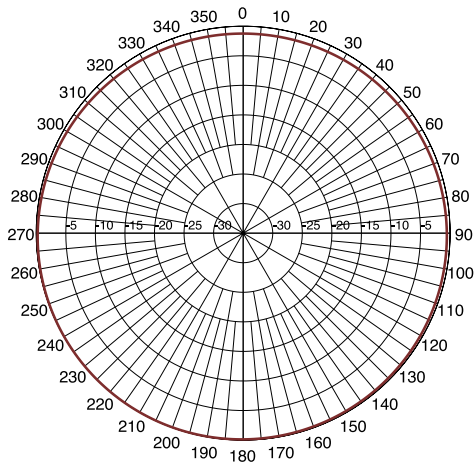

5400MHz - AZ

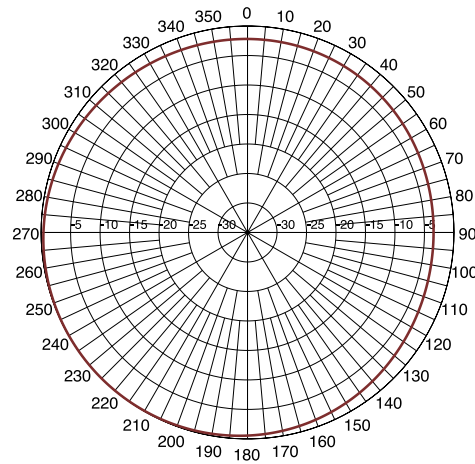

2450MHz - EL PHI90

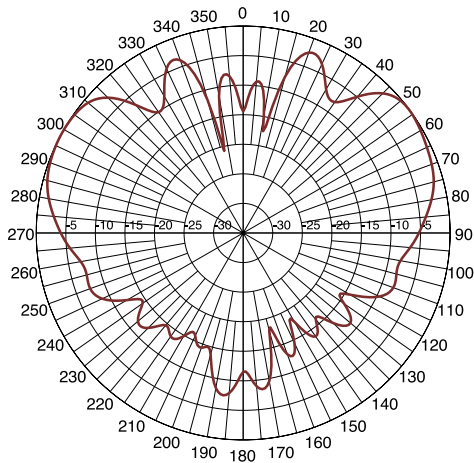

5400MHz - EL PHI90

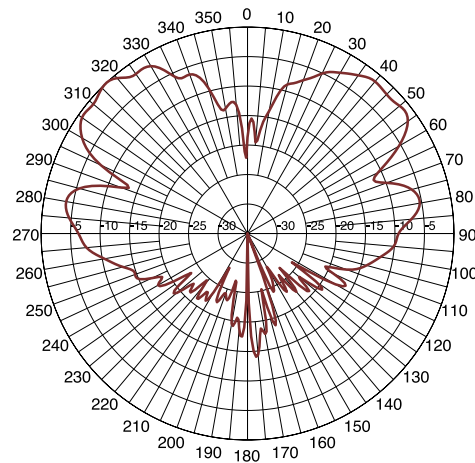

2450MHz - EL PHIO

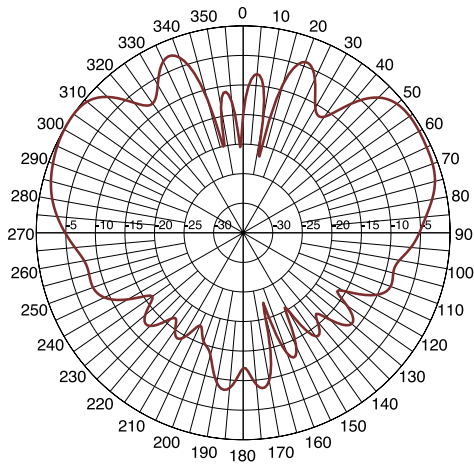

5400MHz - EL PHIO

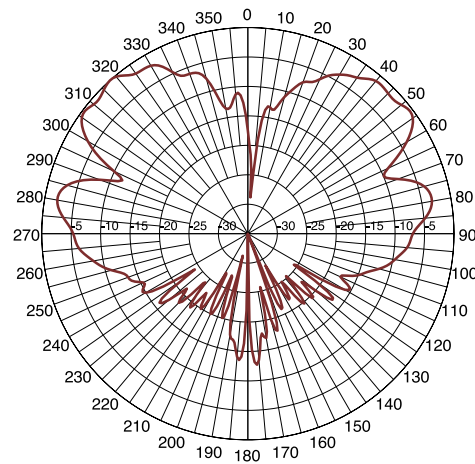

# PCTEL® WiFi Low-Profile Antenna - BMLPV Series

PRODUCT DIMENSIONS (MM)

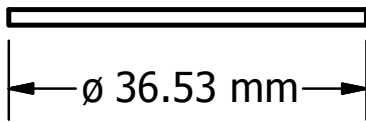
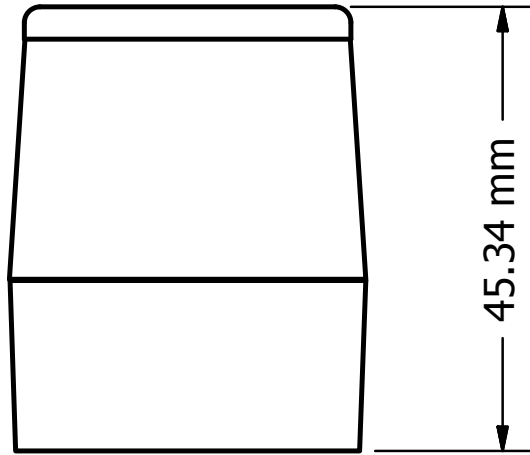

NEOPRENE WASHER

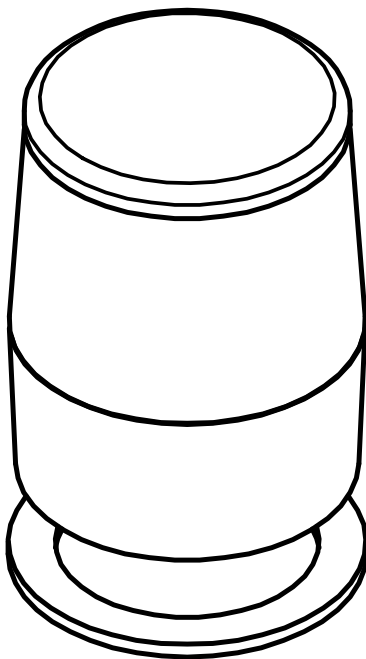

# PCTEL® WiFi Low-Profile Antenna - BMLPV Series

ACCESSORIES

DESCRIPTION	CHARACTERISTICS	ORDER CODE
Antenna mount for mounting the antenna on magnetic surfaces such as switch cabinets or on vehicle roofs	Antenna cable and connector: 360 cm Pro Flex Plus 195 with SMA(m), contact area 89.7 mm	<b>GMLFML195C</b>
Antenna mount for vandalism-proof installation of the antenna by screwing into housing or other surfaces	Vandalism-proof mounting foot for publicly accessible areas. Antenna connector N(f) directly on the mount	<b>MVPHP</b>
Standard antenna base for screw mounting	Mounting foot for screw mounting, antenna plug N(f) directly on the mount	<b>MTPM80</b>
Wall mounting bracket for mounting the antenna on vertical (outside) walls	Dimensions 60x80x50 mm, stainless steel bracket with holder for N(f) plug	<b>WA-Mount-NF-1</b>
Mast mounting bracket for mounting the antenna on steel tubes	Aluminium L-bracket for parallel or vertical mounting on pipes or masts. Suitable for pipes and masts with 38 - 60 mm outer diameter. Hole with 15.8 mm diameter for connectors	<b>BAM1009</b>
Magnetic base mounting bracket for vertical, metallic surfaces	Dimensions 60x80x50 mm, stainless steel bracket with holder for N(f) plug. Strong magnet included in the set	<b>WA-Mount-NF-3</b>

# PCTEL® WiFi Low-Profile Antenna - BMLPV Series

ACCESSORIES



**GMLFML195C**  
**Antenna Mount**  
Magnetic base for mounting antennas on metallic surfaces. 360 cm Pro-Flex Plus with SMA (m) connector



**MVPHP**  
**Antenna Mount**  
Mounting foot for the vandalism-proof installation of antennas by means of a feed-through. Plug N (f)



**MTPM800**  
**Antenna Mount**  
Mounting foot for mounting antennas by means of a feed-through. Plug N (f)



**WA-Mount-NF-1**  
**Antenna Mount**  
Stainless steel wall mounting bracket with 16.5 mm mounting hole for antennas. The holes for wall mounting can also be used for cable ties.



**BAM1009**  
**Antenna Mount**  
Aluminium L-bracket for horizontal or vertical mounting on pipes or masts. Suitable for pipes and masts with 38 - 60 mm outer diameter. Hole with 15.8 mm diameter for mounting with N(f) connectors.



**WA-Mount-NF-3**  
**Antenna Mount**  
Stainless steel wall mounting bracket with 16.5 mm mounting hole for antennas. Mounting on metallic surfaces via enclosed magnets. The holes for wall mounting can also be used for cable ties.

# PCTEL® WiFi Low-Profile Antenna - BMLPV Series

ACCESSORIES ANTENNA CABLE

For mounting bases MVPHP and MTPM800

ANTENNA CABLE TYPE / LENGTH	ANTENNAS-CONNECTION LEFT	ANTENNAS-CONNECTION RIGHT	ORDER CODE
RF195 / 50 cm	N (m)	SMA (m)	NOM00-1950050-S0M00
RF195 / 100 cm	N (m)	SMA (m)	NOM00-1950100-S0M00
RF195 / 300 cm	N (m)	SMA (m)	NOM00-1950300-S0M00
RF195 / 500 cm	N (m)	SMA (m)	NOM00-1950500-S0M00
RF195 / 1000 cm	N (m)	SMA (m)	NOM00-1951000-S0M00
RF195 / 50 cm	N (m)	TNC (m)	NOM00-1950050-T0M00
RF195 / 100 cm	N (m)	TNC (m)	NOM00-1950100-T0M00
RF195 / 300 cm	N (m)	TNC (m)	NOM00-1950300-T0M00
RF195 / 500 cm	N (m)	TNC (m)	NOM00-1950500-T0M00
RF195 / 1000 cm	N (m)	TNC (m)	NOM00-1951000-T0M00



## Antenna cable - Configurator

With the Welotec cable configurator it is easy, to find the right coax cable for your needs.

Choose your desired cable from a large selection on cable types and combine it with the suitable connection.

### Available connections:

SMA, RP-SMA, TNC, RP-TNC, BNC, N

### Available cable types:

RG174, RF195, Aircell 5, RG58, RG223, H155 PE, Aircell 7